

- SAVE THESE INSTRUCTIONS.**
- This product is for household use only.
- When blending hot liquids, remove center piece of two-piece cover.
 - Always operate blender with cover in place.
 - To reduce the risk of injury, never place cutter-assembly blades on base without jar properly attached.
 - Blades are sharp. Handle carefully.
 - Blender is not running.
 - A scraper may be used, but must be used only when the blender. To reduce the risk of severe injury to persons or damage to the
 - Keep hands and utensils out of container while blending to
 - Do not let cord hang over edge of table or counter.
 - Do not use outdoors.
 - shock or injury.
 - The use of attachments, including canning jars, not recommended by the manufacturer may cause fire, electric
 - If the power supply cord is damaged, it should be replaced by qualified personnel or in Latin America by an authorized service center.

- The cord of this appliance was selected to reduce the possibility of tangling in or tripping over a longer cord. If more length is needed, use an extension cord rated no less than 15-amperes. (For 220 volts rated products, use an extension cord rated no less than 6-amperes). When using an extension cord, do not let it drape over the working area or dangle where someone could accidentally trip over it. Handle cord carefully for longer life; avoid jerking or straining it at outlet and appliance connections
- If the power supply cord is damaged, it should be replaced by qualified personnel or in Latin America by an authorized service center.
- The use of attachments, including canning jars, not recommended by the manufacturer may cause fire, electric shock or injury.
- Do not use outdoors.
- Do not let cord hang over edge of table or counter.
- Keep hands and utensils out of container while blending to reduce the risk of severe injury to persons or damage to the blender. A scraper may be used, but must be used only when the blender is not running.
- Blades are sharp. Handle carefully.
- To reduce the risk of injury, never place cutter-assembly blades on base without jar properly attached.
- Always operate blender with cover in place.
- When blending hot liquids, remove center piece of two-piece cover.

IMPORTANT SAFEGUARDS

Please Read and Save this Use and Care Book.



CRUSH MASTER® 10-SPEED BLENDER LICUADORA CRUSH MASTER® DE 10 VELOCIDADES

Customer Care Line:
USA
1-800-231-9786
Mexico
01-800 714-2503
Accesorios/Parts (USA)
Accesorios/Partes (EE.UU)
1-800-738-0245

For online customer service and to register your product, go to www.prodprotect.com/applica For US residents only.

MODEL/MODELO

- BL10471



2009/11-12-42E/5

Sello del Distribuidor:	Comercializado por: Applica Manufacturing, S. de R. L. de C.V. Presidente Mazarik No 111, 1er Piso Col. Chapultepec Morales, Mexico D.F Deleg. Miguel Hidalgo CP 11570 MEXICO
Fecha de compra:	Servicio y Reparación aArt. 123 No. 95 Col. Centro, C.P. 06050 Deleg. Cuauhtemoc
Modelo:	Servicio al Consumidor Venta de Refacciones y Accesorios 01 800 714 2503

Código de fecha / Date Code	475 W 120 V ~ 60 Hz
-----------------------------	---------------------



Copyright © 2009 Applica Consumer Products, Inc.

Fabricado en la República Popular de China
Impreso en la República Popular de China

Made in People's Republic of China
Printed in People's Republic of China

Importado por / Imported by:

APPLICA AMERICAS, INC.
Av. Juan B Justo 637 Piso 10
(C1425FSA) Ciudad Autonoma de Buenos Aires
Argentina
C.U.I.T No. 30-69729892-0

Importado por / Imported by:

APPLICA MANUFACTURING, S. DE R. L. DE C. V.
Presidente Mazarik No 111, 1er Piso
Col. Chapultepec Morales, Mexico D.F
Deleg. Miguel Hidalgo
CP 11570
MEXICO
Teléfono: (55) 5263-9900
Del interior marque sin costo
01 (800) 714 2503

- Note: † indicates consumer replaceable/removable parts
- † 1. Lid cap (Part # 081049)
 - † 2. Lid (Part # 081050DZ102)
 - † 3. Jar (Part # 081048F1)
 - † 4. Handle
 - † 5. Gasket (Part # 091511)
 - † 6. Blade assembly (Part # 77904)
 - † 7. Jar base (Part # 03473-2DZ101)
 8. Unit base
 9. Controls (see B)

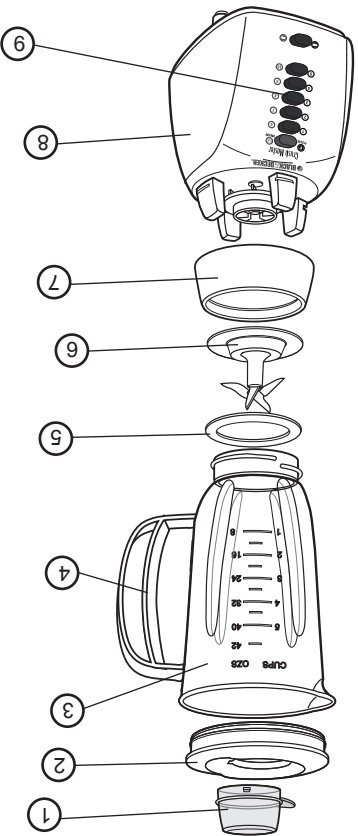

Product may vary slightly from what is illustrated.

NEED HELP?

For service, repair or any questions regarding your appliance, call the appropriate 800 number on cover of this book. Please **DO NOT** return the product to the place of purchase. Also, please **DO NOT** mail product back to manufacturer, nor bring it to a service center. You may also want to consult the website listed on the cover of this manual.

**Two-Year Limited Warranty
(Applies only in the United States)**

What does it cover?

- Any defect in material or workmanship provided; however, Applica's liability will not exceed the purchase price of product.

For how long?

- Two years after date of purchase.

What will we do to help you?

- Provide you with a reasonably similar replacement product that is either new or factory refurbished.

How do you get service?

- Save your receipt as proof of date of sale.
- Visit the online service website at www.prodprotect.com/applica, or call toll-free 1-800-231-9786, for general warranty service.

- If you need parts or accessories, please call 1-800-738-0245.

What does your warranty not cover?

- Damage from commercial use
- Damage from misuse, abuse or neglect
- Products that have been modified in any way
- Products used or serviced outside the country of purchase
- Glass parts and other accessory items that are packed with the unit
- Shipping and handling costs associated with the replacement of the unit
- Consequential or incidental damages (Please note, however, that some states do not allow the exclusion or limitation of consequential or incidental damages, so this limitation may not apply to you.)

How does state law relate to this warranty?

- This warranty gives you specific legal rights. You may also have other rights that vary from state to state or province to province.

BLACK & DECKER is a registered trademark of The Black & Decker Corporation, Towson, Maryland, USA

4. Choose the speed that best suits your task for food or beverage blending (B). Press the LOW/HI button in combination with the task button when choosing or switching speeds.
5. Use the Pulse (P) button for a few seconds, then release for quick or delicate blending tasks. Releasing the pulse automatically turns the blender off.
6. If you want to add ingredients while the blender is on, remove the lid cap and drop ingredients through the lid opening.
7. When finished blending, push the on/off button (O). To remove the jar, grasp the handle, twist toward the unlock (U) and lift it from the unit base. Remove the lid before pouring.

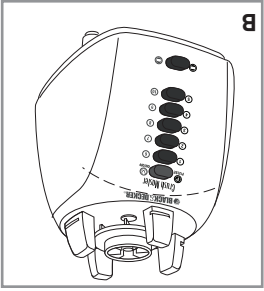

1. Be sure the unit is off and plug the cord into a standard electrical outlet.
2. Place the food to be blended into the jar and the lid on the jar before blending.
3. Be sure that the lid cap is in place. When crushing ice or hard foods, keep one hand on the lid.

USING YOUR BLENDER

1. Before first use, wash all parts except the unit base. Put the gasket on top of the blade assembly.
2. Place the blade assembly into the jar base and turn the jar base clockwise until tight (A).
3. Interlock System: Place the assembled jar onto the unit base and turn toward lock (L) until secured in place. You've engaged the interlock system if you lift the jar handle and the entire blender lifts together as one unit.

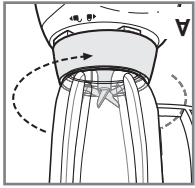

BLENDER JAR ASSEMBLY

- Wipe outside of appliance with a damp cloth; dry thoroughly.
- Wash all removable parts as instructed in CARE AND CLEANING section of this manual.
- Please go to www.prodprotect.com/applica to register your warranty.
- Remove and save literature.
- Remove all packing material and any stickers from the product.

GETTING STARTED

This product is for household use only.

How to Use

BLENDING TIPS AND TECHNIQUES

- Cut food into small pieces about ¾" [2 cm] before adding to the blender.
- When ingredients stick or spatter along the sides of the jar, stop the blending action and remove the lid. Use a rubber spatula to push food toward the blades. Replace the lid, then continue blending.
- Some of the tasks that cannot be performed efficiently with a blender are: beating egg whites, whipping cream, mashing potatoes, grinding meats, mixing dough, and extracting juices from fruits and vegetables.
- The following items should never be placed in the unit as they may cause damage: dried spices and herbs (ground alone), bones, large pieces of solidly frozen foods, tough foods such as turnips.

Care and Cleaning

This product contains no user serviceable parts. Refer service to qualified service personnel.

Important: To maintain performance, dry blades after cleaning.

1. The fast clean feature helps make it easier to clean the blender jar by loosening food particles. You may use the fast clean feature by filling the jar half full with lukewarm water. Add a little dish detergent for tough cleaning jobs (such as after making salsa, shakes, or salad dressing). Hold the lid and press any button. Let the unit run for about 5 seconds, then press the on/off (O) button.
 2. Unplug the unit, twist to unlock (U), lift the jar off the unit base, and rinse.
 3. Parts may be hand-washed. Follow the cleaning instructions below.
- For hand washing parts:**
1. Before cleaning, turn off and unplug the blender.
 2. Rinse parts immediately after blending for easier cleanup.
 3. Wipe the unit base with a damp cloth and dry thoroughly. Remove stubborn spots by rubbing with a damp cloth and non-abrasive cleaner. Do not immerse the base in liquid.
 4. Removable parts can be washed by hand or in a dishwasher. Do not place jars or parts in boiling liquids.
 5. If liquids spill into the base, wipe with a damp cloth and dry thoroughly. Do not use rough scouring pads or cleansers on parts or finish.

